

Florenz 6060 Leuchtenprofil

- high-quality aluminium profile, anodized, natural tone, or powder-coated in traffic white (RAL 9016) or deep black (RAL 9005)
- can be used flexibly as a surface-mounted or luminaire profile
- direct and indirect (continuous) lighting solution
- improved clip-in technology of the multifunctional insert
- power supply units with a form factor of 30 x 21 mm can be integrated
- a homogeneous light line is possible in conjunction with the opal white diffusers and the appropriate LEDlight flex (up to pitch 22)
- further RAL powder coatings on request

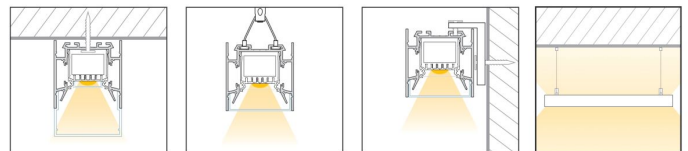

Please refer to the notes on expansion and assembly at the end of the data sheet!



ALUMINIUM PROFILE

	62390052	62390052_9005	62390052_9016
Description	Florenz 6060 Leuchtenprofil		
Mounting type	surface-mounted; Abhängeseil		
Colour	aluminium	black RAL 9005	white RAL 9016
Length	2010 mm		
Width	60 mm		
Height	60 mm		
Material	Aluminium EN AW 6060		
Finish	anodised	powder-coated	

For other lengths please replace the last digit of the article number by: 3 = 3.02m / 5 = 5.03m

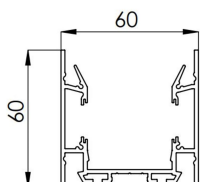

INLAY

	62390012	62390013	62390015
Description	Florenz 40/60 Einlegeprofil		
Material	Aluminium EN AW 6060		
Finish	anodised		
Colour	aluminium		
Length	2010 mm	3020 mm	5030 mm
Width	36 mm		
Height	35,65 mm		
Remarks	zur Aufnahme des LED-Streifens		



COVER

	62390072	62390082	62398912	62398922	62398932
Description	Abdeckung opalweiß/klar 180°, für eine seitlich homogene Lichtverteilung	Abdeckung opalweiß/opalweiß 180°, für eine rundum homogene Lichtverteilung	Diffuser clear, for maximum light yield and protection of the LED strip	Diffuser satined, for a diffused light distribution and concealment of the technology	Diffuser opal, for a homogenous and glare-free light distribution
Material	PMMA				
Version	opalweiß/klar	opalweiß/opalweiß	clear	satined	opal white
Length	2010 mm				
Width	61,3 mm		55,8 mm		
Height	40 mm		15 mm		

ABDECKUNGEN INDIREKT

	62398202	62398212	62398222
Description	Diffuser flat, clear, for maximum light yield and protection of the LED strip	Diffuser flat, opal, for a glarefree light distribution and concealment of the technology	Diffuser flat, satined, for a diffused light distribution and concealment of the technology
Material	PMMA		
Version	clear	opal white	satined
Transmission in %	98	76	92
Length	2010 mm		
Width	15,6 mm		
Height	3,8 mm		

BLINDABDECKUNG

	62390062	62390062_9005	62390062_9016
Description	Florenz 60 Blindabdeckung		
Colour	aluminium	black RAL 9005	white RAL 9016
Length	2010 mm		
Width	55,8 mm		
Height	15 mm		
Material	Aluminium EN AW 6060		
Finish	anodised	powder-coated	

For other lengths please replace the last digit of the article number by: 3 = 3.02m / 5 = 5.03m



END CAPS

	62390058	62390058_9005	62390058_9016
Description	Florenz 6060 Endkappenset (2 St.) - schraublose Sichtfläche		
Material	Aluminium EN AW 6060		
Colour	aluminium	black RAL 9005	white RAL 9016
Length	2 mm		
Width	60 mm		
Height	60 mm		

	62390059	62390059_9005	62390059_9016
Description	Florenz 6060 Endkappenset (2 St.) - mit je 4 Schrauben		
Material	Aluminium EN AW 6060		
Colour	aluminium	black RAL 9005	white RAL 9016
Length	2 mm		
Width	60 mm		
Height	60 mm		

Note: The screws for the end caps must be placed and screwed in at a right angle (90°) to the screw channel and may only be screwed in with a max. tightening torque of 0.75 Nm to prevent the screw head from unscrewing or the screw from overtightening (recommended bit PH1).

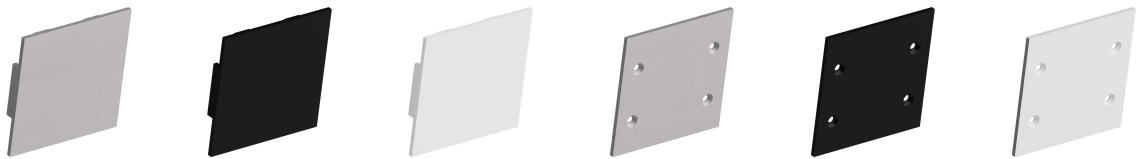

ANGLE BRACKETS

	62390007	62390007_9005	62390007_9016
Description	Florenz 4050 Winkelhalter		
Material	aluminium		
Colour	aluminium	black RAL 9005	white RAL 9016
Length	40 mm		
Width	40 mm		
Height	17,5 mm		
Remarks	für eine 90° Wandmontage		

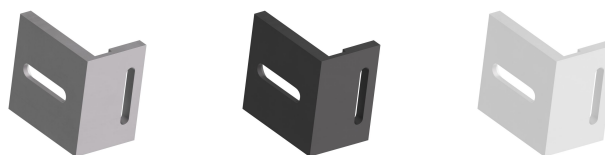

ACCESSORIES

	62390070	62390150	62390151	62390154
Description	Folienband ID linear, Diffusor mit Längsentblendung (für 180° Abdeckung)	Reflektorband, selbstklebend	Folienband ID linear, Diffusor zur Längsentblendung (für flache Abdeckung)	Folienband Glare Control, zur Entblendung
Material	plastics			
Length	10000 mm	3000 mm	10000 mm	
Width	56,5 mm	10 mm	52,3 mm	33,2 mm
Height	0,21 mm	0,23 mm	0,21 mm	0,35 mm

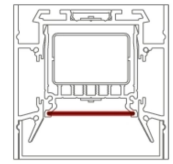
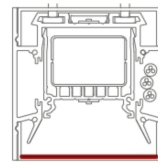
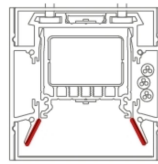
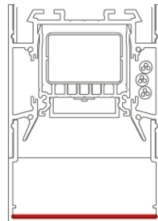

	62390056	62390090	62390097	62390098
Description	Florenz 60 Deckenhalter Set	Durchführungstülle	Florenz 40/60 Verbinder 90°	Florenz 40/60 Verbinder gerade
Material	Aluminium EN AW 6060	EPDM	304 stainless steel	
Finish	anodised			
Colour	aluminium	schwarz		
Length	100 mm	9 mm	65,8 mm	80 mm
Width	55,8 mm		65,8 mm	8,5 mm
Height	15 mm		2 mm	
Diameter		19 mm		

	62390091	62390091_9005	62390095	62390096
Description	Florenz 40/60 Y-Seilabhängung vernickelt	Florenz 40/60 Y-Seilabhängung schwarz	Florenz 40/60 Abhängeseil	Florenz 40/60 Abhängeseil schwarz
Finish	nickel-plated		nickel-plated	
Colour		black RAL 9005		schwarz
Length	3000 mm		5000 mm	
Width	1,2 mm			
Remarks	2er Set inkl. Deckenbefestiger Traglast 12 kg je Seil		1 Stück Traglast 12 kg je Seil	



All aluminium profiles and covers are subject to certain length tolerances. This is +20/-0 mm irrespective of the length, i.e. a profile has at least the specified length, but can be up to 20 mm longer.

If you require an exact length, please specify this when ordering (article number 62397000).

Please note that the materials aluminum and PMMA can expand when the temperature changes vary greatly. With a temperature change of 20°C the expansion difference can be up to 1.2 mm per meter! This is no deficiency of the product but a normal physical process.

Installation note: If you directly install two aluminum profiles edge to edge (without end caps), please pay attention during installation, that you don't glue the LED strip directly over the joint, since the profiles at temperature fluctuations - especially at large lengths - will expand/contract (s. section 1) and then the LED tape may be damaged. At joints the LED strip has to be cut at the marked positions and reconnected with flexible solder bridges with corresponding expansion reserve (min. 5mm).

Installation situations



Abbildung ähnlich

Intended Use

Profile:

- The LED profiles are a component for the reception of LED strips approved for this purpose. In combination with optional accessories such as covers, end caps, inserts, etc., LED luminaires can be produced which are used exclusively for general lighting or accent lighting and therefore do not serve emergency or safety lighting in particular.
- The assembly is carried out via appropriate holders or suspensions, which are offered as accessories. For brackets we recommend 3 brackets per running meter. The profiles are designed for mounting on a stable and straight surface. Depending on the substrate and local conditions, a higher number of brackets may be required and/or the installation material supplied (screws/plugs) must be replaced with suitable mounting material. The brackets must not be bent during assembly, as this has an influence on the holding force. It may not be possible to use the holders provided. Alternatively, the profile can be screwed directly to the substrate. In any case, the installer must ensure that the system is held securely.
- Make sure that the profile expands due to thermal influences. Sufficient space must be kept available for this purpose..
- The mounting instructions for the LED strips and power supplies must be viewed separately.
- The profile is to be used exclusively for the above shown installation situations.

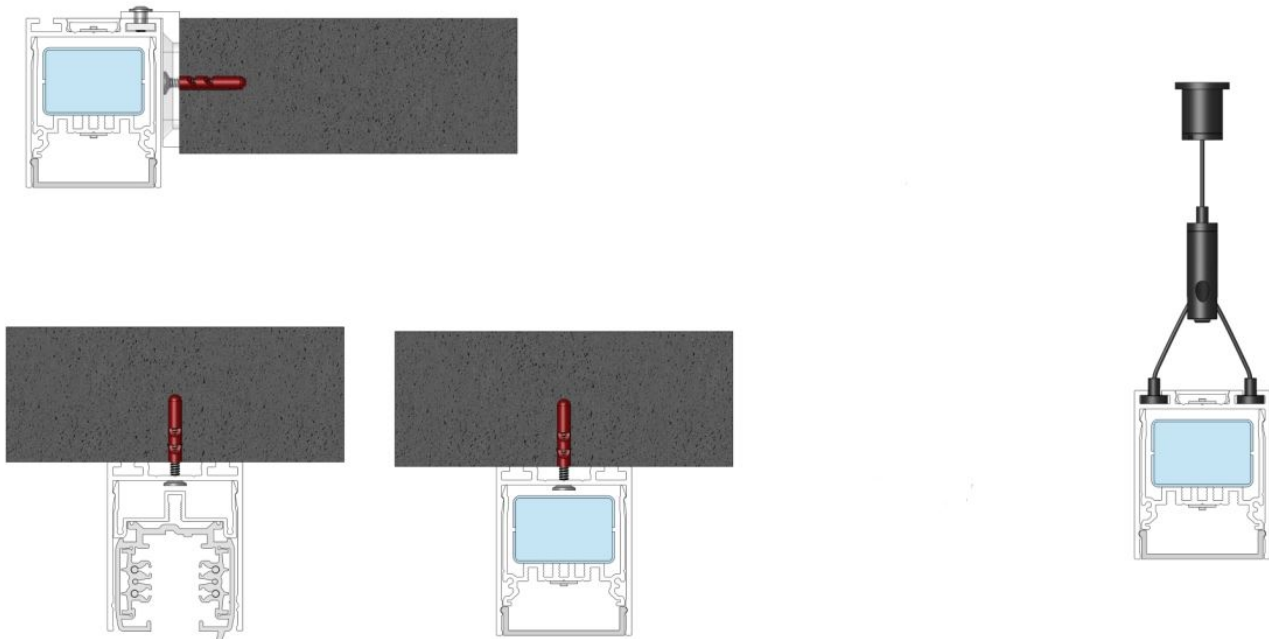
Covers:

- All plastic covers made of PMMA have first-class photometric properties, but are very brittle due to the material, which means that the cover can splinter when subjected to mechanical influences (bending, sawing, other processing). There is a risk of injury, wear safety glasses and gloves! Plastic covers made of PC are not affected.
- PMMA or PC have a higher coefficient of thermal expansion than aluminium. This means that light slits may appear at the joints and terminations of the plastic covers, especially when the unit is not yet at operating temperature..
- To ensure that the cover is held securely, it must be clipped into the holding groove provided for this purpose along its entire length. In any case, the installer must ensure that the system is held securely.
- Alcoholic detergents remove plasticizers from the plastic profiles, which means that they lose their flexibility and can form cracks even when installed. We recommend cleaning only with a damp (clear water), soft cloth.

Accessories (end caps, holders, etc.):

- An LED profile and its accessories are not toys - these components may only be operated by persons who can assess the risks involved in handling them. There is a danger of swallowing small parts.

NOTES

Press marks or slight scratches on profiles are production-related and do not constitute a defect.

Loose, wipeable impurities may appear on the aluminum and plastic profiles. This is due to the production and its handling and does not represent a defect. We generally recommend cleaning the profiles with a soft, lint-free cloth (if necessary with a little clear water) before installation. The LED bonding surface must also be free of grease to ensure good adhesion of the LED strip. Corresponding information can be found in the instructions for the LED strips.

The adhesion of our LEDlight flex strips to the profiles we offer and their different surfaces has been tested and can be ensured if the processing instructions are followed. If there are adhesion problems between LED strips and aluminum profiles, we recommend pre-treatment with the adhesion promoter "3M™ Tape Primer 94".

The guarantee period for the product is 5 years and begins on the day of shipment. Reference is the date of the delivery bill. The guarantee period may differ for accessories.